

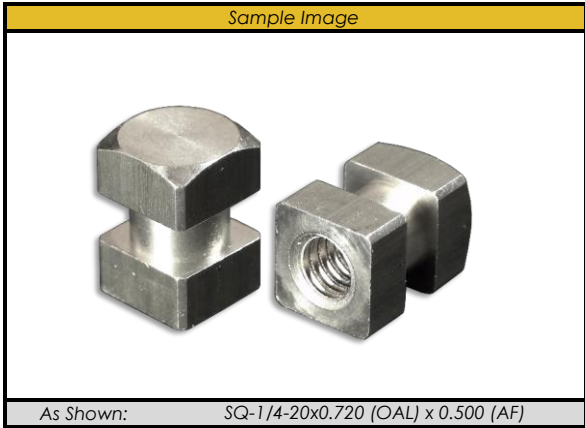

Rotaloc Square Inserts

Rotaloc International, LLC



Common Insert Sizes

Thread Size (Inch)	OAL	AF
#8-32	0.500"	0.375"
#10-24	0.750"	0.375"
#10-32	0.375"	0.375"
1/4-20	0.650"	0.375"
1/4-20	0.720"	0.500"
5/16-18	0.750"	0.500"
3/8-16	0.750"	0.500"
1/2-13	0.875"	0.750"

Thread Size (Metric)	OAL	AF
M5x0.80	12.7mm	9.5mm
M6x1.00	15mm	10mm
M8x1.25	20mm	14mm
M10x1.50	25mm	19mm

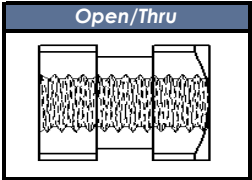
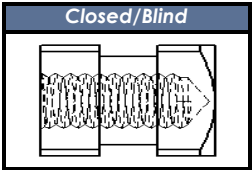

Contact Rotaloc for additional sizes

Sizing Key & Product Description

Material Options	Plating Options	Sizing							
AL - Aluminum	Trivalent Zinc (TZP)	Thd	OAL	AF	TL	H1	H2	Gh	Gd
BR - Brass	Nano Plating								
SS - Stainless Steel	E-Coat	Thread Size	Overall Length	Across Flat Dimension	Thread Length	Square Height Top	Square Height Bottom	Groove Height	Groove Diameter
ST - Zinc Plated Steel	Other finishes available								

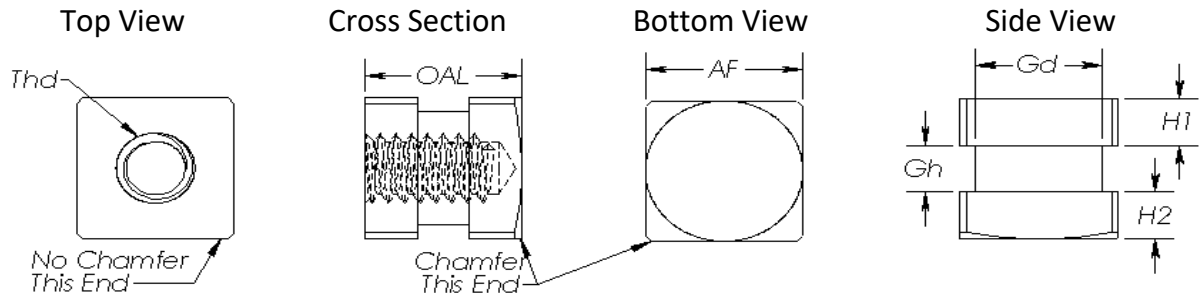

Contact Rotaloc for Prices and Sizing.

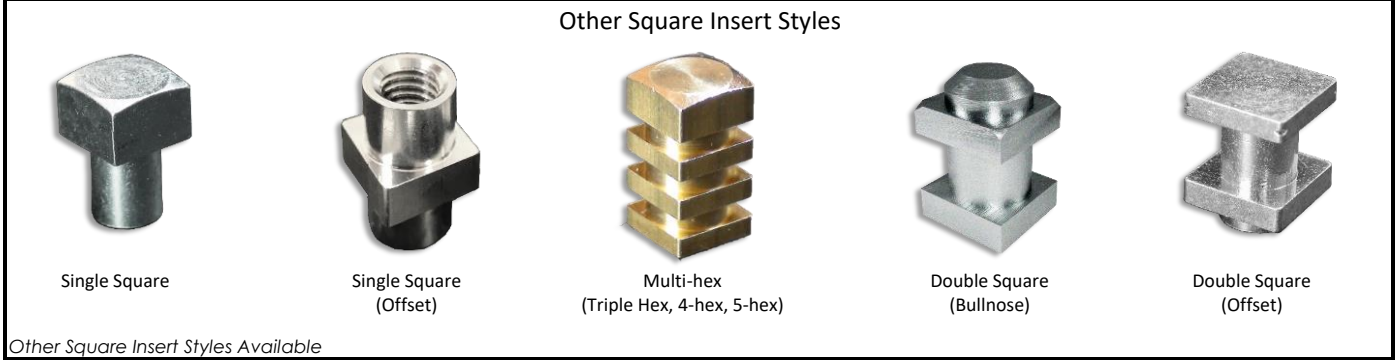

All plating and materials offered are RoHS and REACH Compliant

Many common sizes in stock. Contact Rotaloc® for availability. A Rotaloc® Representative will be happy to discuss your specific application and product specifications.

Contact Us:
Tel (303) 948-5434 or Toll Free (888) Rotaloc or (888)-768-2562
www.rotaloc.com | info@rotaloc.com

Address
Rotaloc International, LLC
9903 Titan Court, Suite #15, Littleton, CO 80125 - USA

Value - Quality - Service

Rotaloc® is a Registered Trademark of Rotaloc International, LLC - Copyright © 2012